



BUILDING DEPT. REFERENCE # 372,601

ADDRESS OF PROPERTY 9 ORCHARD ST. COLD SPRING
10516-1905

TAX MAP # 49.5-2-7

NAME(S) OF APPLICANT ANITA PELTONEN
MATTI PELTONEN

HISTORIC DISTRICT REVIEW BOARD
APPLICATION FOR CERTIFICATE OF APPROPRIATENESS

PAID KH
MAY 07 2024
cl # 233
Village of Cold Spring

Please complete the following information and submit six copies, along with compiled supporting materials (see checklist) and the required filing fee, by the last Monday of the month. With the exception of signs, applications for Certificates of Appropriateness cannot be submitted without a prior referral from the Building Inspector.

If you have questions or need assistance completing this form, please contact the Village Clerk at 845-265-3611 or vcscclerk@coldspringny.gov.

Incomplete applications or applications received after the deadline cannot be included in the monthly agenda.

Property Owner(s) / Applicant(s)

Signature

ANITA PELTONEN MATTI PELTONEN

Email Address

Telephone Number 917 561 8741

Mailing Address

mmpelto@hotmail.com or peltonena@yahoo.com
845 265 4264
9 ORCHARD STREET
COLD SPRING, NY 10516-1905

*If the Applicant is not the Property Owner, complete the attached Property Owner's Endorsement.

Project Narrative

Describe the work you propose in sufficient detail to communicate a clear sense of the project.

Replace broken-down shed in backyard with new shed in the same material = wood/style. Door to be hand-hewn. Window(s) will be made by Putnam Windows/All in same style as in images attached.

FOR INTERNAL USE ONLY

Date Received _____ Application Sequence Number _____

- Application Fee Paid
- HDRB Referral
- Planning Board Referral
- Building Inspector Referral
- ZBA Referral



BUILDING DEPT. REFERENCE #

372601

ADDRESS OF PROPERTY

9 ORCHARD ST. 10516
COLD SPRING 1905

TAX MAP #

49.5-2-7

NAME(S) OF APPLICANT

Amita Peltonen
Matu Peltonen

**HISTORIC DISTRICT REVIEW BOARD
APPLICATION FOR CERTIFICATE OF APPROPRIATENESS**

DISCLOSURE OF OFFICIAL INTERESTS STATEMENT

A. Nature and Extent of Interest of any State Official or Municipal Officer or Employee in this Application:

NONE

B. Statement of no interest in any State Official or Municipal Officer or Employee in this Application:

The undersigned Applicant making this request certifies by signature on this Disclosure Statement that, in accordance with the Provisions of §809 of the General Municipal Law, except as stated in "A" above, no State Officer, or any officer or employee of the Village of Cold Spring or any municipality of which the Village is a part has any interest in the person or firm (partnership or association) making the above application.

Applicant

Title

Signature

Date



BUILDING DEPT. REFERENCE #

372601

ADDRESS OF PROPERTY

9 ORCHARD ST. Cold Spring
10516-1905

TAX MAP #

49.5-2-7

NAME(S) OF APPLICANT

Anita Peltanen
Matti Peltanen

**HISTORIC DISTRICT REVIEW BOARD
APPLICATION FOR CERTIFICATE OF APPROPRIATENESS**

OWNER'S ENDORSEMENT

In the event that the applicant is not the legal property owner, please sign and return a notarized copy of this declaration along with your application.

*Yes we are residents
+ property owners
of 9 Orchard St.*

_____, being duly sworn, deposes and says that (s) he resides at _____
_____, (owner's home address), in the County of _____,
State of _____ and that (s) he is (the owner in fee) or _____
of the Corporation which is the owner in fee of the premises under review above and described in the
foregoing application and that (s) he has authorized the applicant above to make the foregoing applica-
tion as described herein and that (s) he agrees to be bound by all statements, conditions and representa-
tions contained therein as if (s) he had so petitioned.

Property Owner

Signature

Email Address

Telephone Number

Sworn to before me on this date

Notary Public of the State of New York



BUILDING DEPT. REFERENCE #

372601

ADDRESS OF PROPERTY

90 RICHARD ST. COLD SPRING
10516-1905

TAX MAP #

49.5-2-7

NAME(S) OF APPLICANT

Anita Peltanen
Matti Peltanen

**HISTORIC DISTRICT REVIEW BOARD
APPLICATION FOR CERTIFICATE OF APPROPRIATENESS**

CONSENT TO SITE VISITS

To be completed by all applicants, and, if different, property owners.

I, the undersigned, understand that in the normal course of adjudicating an application, it may be necessary for members of the HDRB to inspect, closely and in person, details of my property relevant to the application, during daylight hours. While all considerations will be made to arrange for specific, scheduled, on-site meetings, I understand that this may not always be possible in an effort to process all applications in a timely manner, and I consent to allowing HDRB board members to enter upon and pass through such property in order to inspect the project site, without prior notice and without my being present, to conduct such inspections for the duration of my application's review period. I further acknowledge that in the normal course of such a site visit, HDRB board members may take measurements, take photographs, or create drawings/sketches of property features and elements related to the application.

Applicant	<u>ANITA PELTONEN</u>	Signature	<u>[Signature]</u>	Date	<u>5/6/2024</u>
Property Owner (if different)	<u>MATTI PELTONEN</u>	Signature	<u>[Signature]</u>	Date	<u>5/6/24</u>



PROPOSED REPLACEMENT SHED STYLE

SHED
VIEW FROM 12 ORCHARD
STREET
BEHIND FENCE
+ TREES



→ SIDEWALK ← VIEW OF 9 ORCHARD ST. FROM 12 ORCHARD ST.

11 ORCHARD ST. SOUTH SIDE

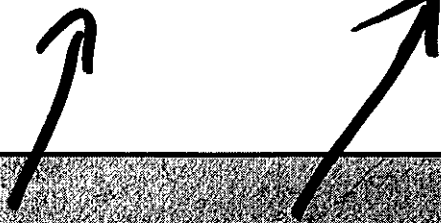

SHED AS
SEEN FROM
11 ORCHARD ST

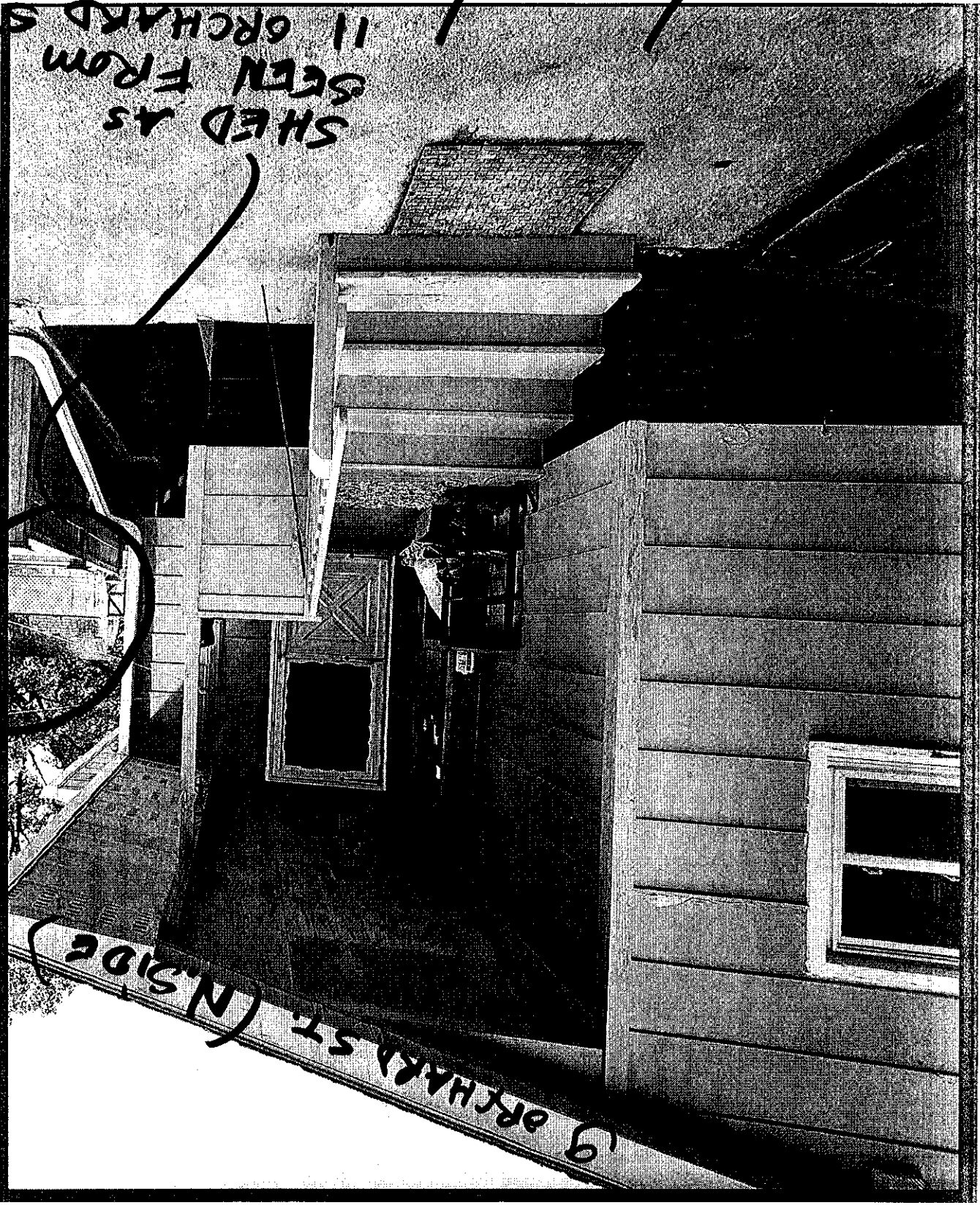

9 ORCHARD ST. (N. SIDE)

VIEW OF G ORCHARD ST. / BELTON MEN
SHED + HOUSE FROM 7 ORCHARD ST.



G ORCHARD

TO STREET

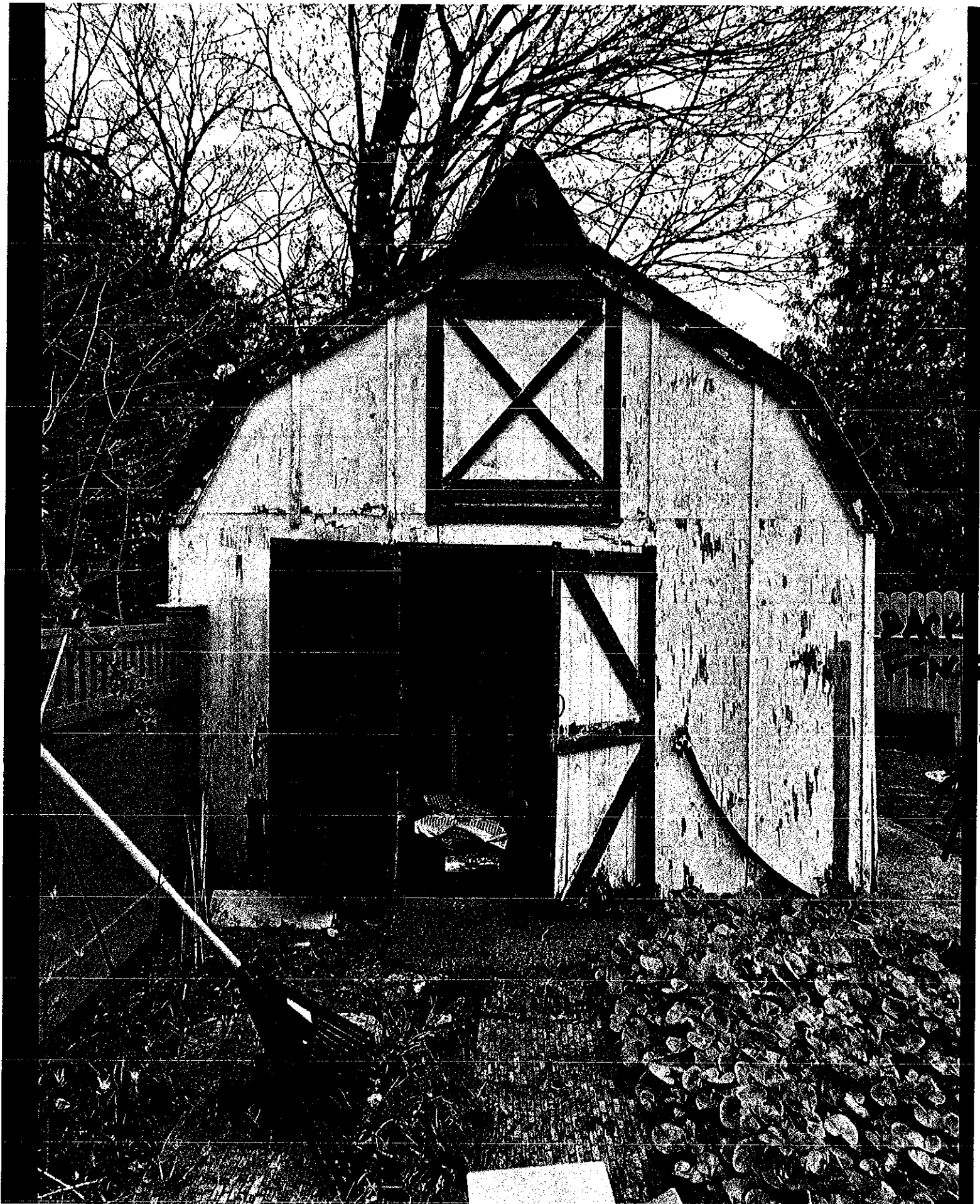

OLD SHED @ 9 ORCHARD - NEW @ SAME LOCATION

INTERIOR
CONDITION
OF
OLD
SHED @ 9 ORCHARD
ST.



Materials

Wood; rough cut pine

Frame - list on next page

Wall cover; 12"x1"

Roof: 12 x 18 dark gray slate, attached to underlying 12 x 1 rough cut pine planks with 1.5" copper nails, the roof ridge is covered with copper flashing

TIMBER LIST FOR THE FRAME

TIMBER TYPE	NOMINAL (INCH) SIZE (WIDTH × DEPTH)	QUANTITY/ LENGTH (FEET)	BF (BOARD FOOTAGE)
<i>Sills</i>	8×8	2/12, 2/16	299
<i>Tie beams</i>	7×8	3/12	168
<i>Plates</i>	7×8	2/18	149
<i>Posts</i>	7×7	6/10	245
<i>Joists</i>	5×7	5/12	175
<i>Rafters</i>	5×5	18/10	375
<i>Wall girts</i>	4×5	5/8, 1/12	87
<i>Door posts</i>	4×5	2/8	27
<i>Collars</i>	3×5	2/10	25
<i>Braces</i>	3×5	7/10*	87.5
<i>Total**</i>			1637.5
<i>Pins</i>		12 1-inch dia., 75 ¾-inch	
<i>Hardwood wedges</i>	2¾ inch at wide end, tapered at ¾ inch in 8 inches	6/12"	Make wedges slightly narrower than 1½ inches

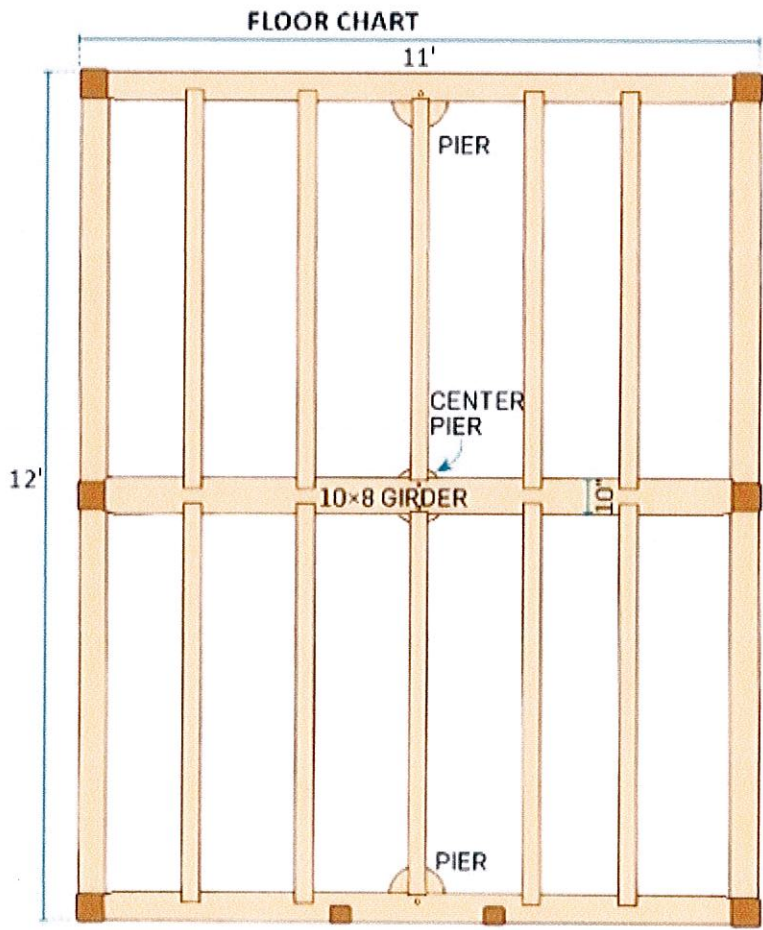

Side facing north (with a door and a window)

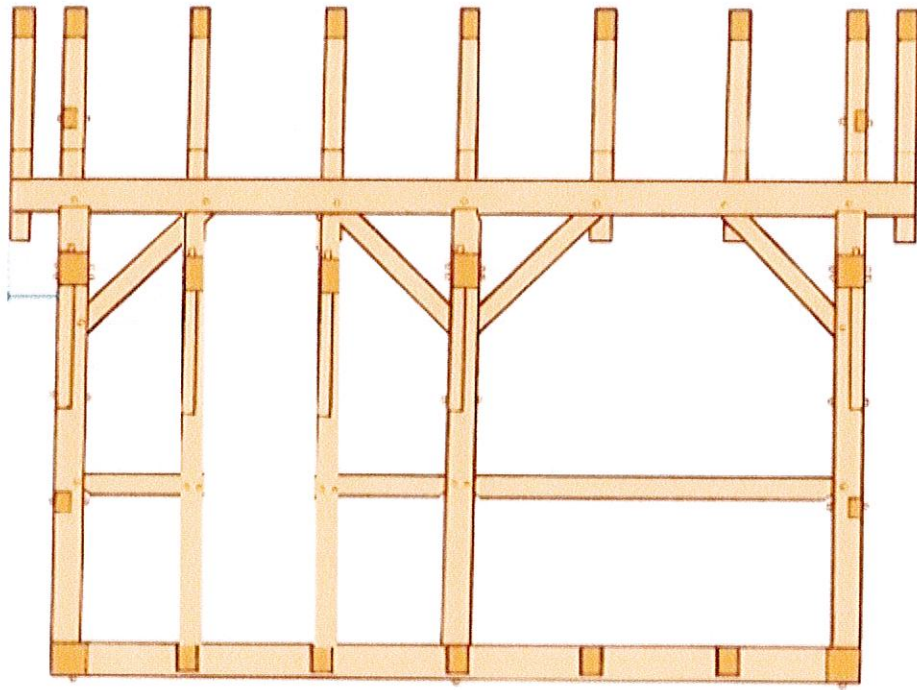

Side facing south

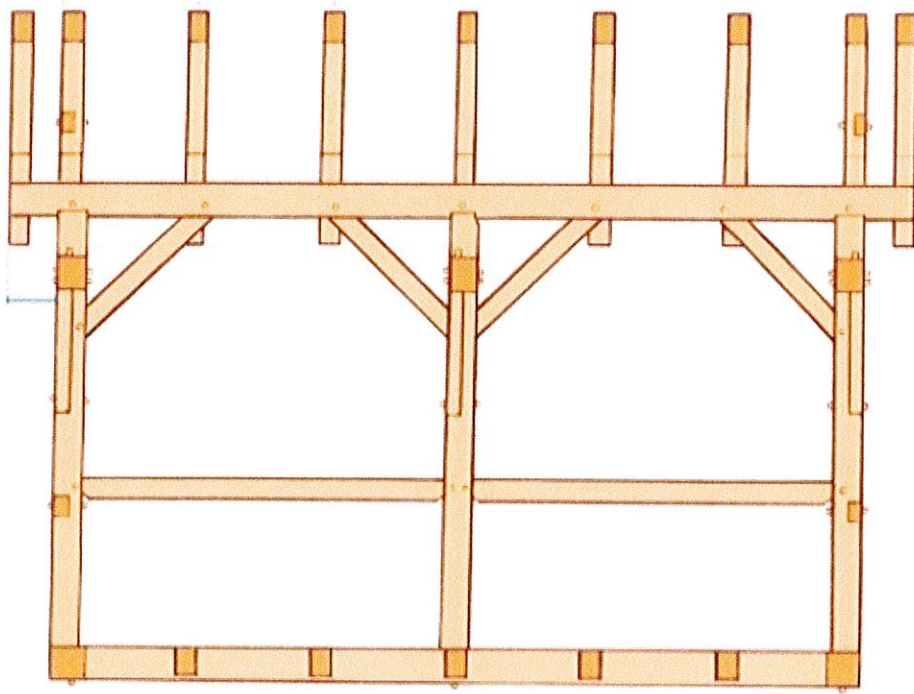

East and west side

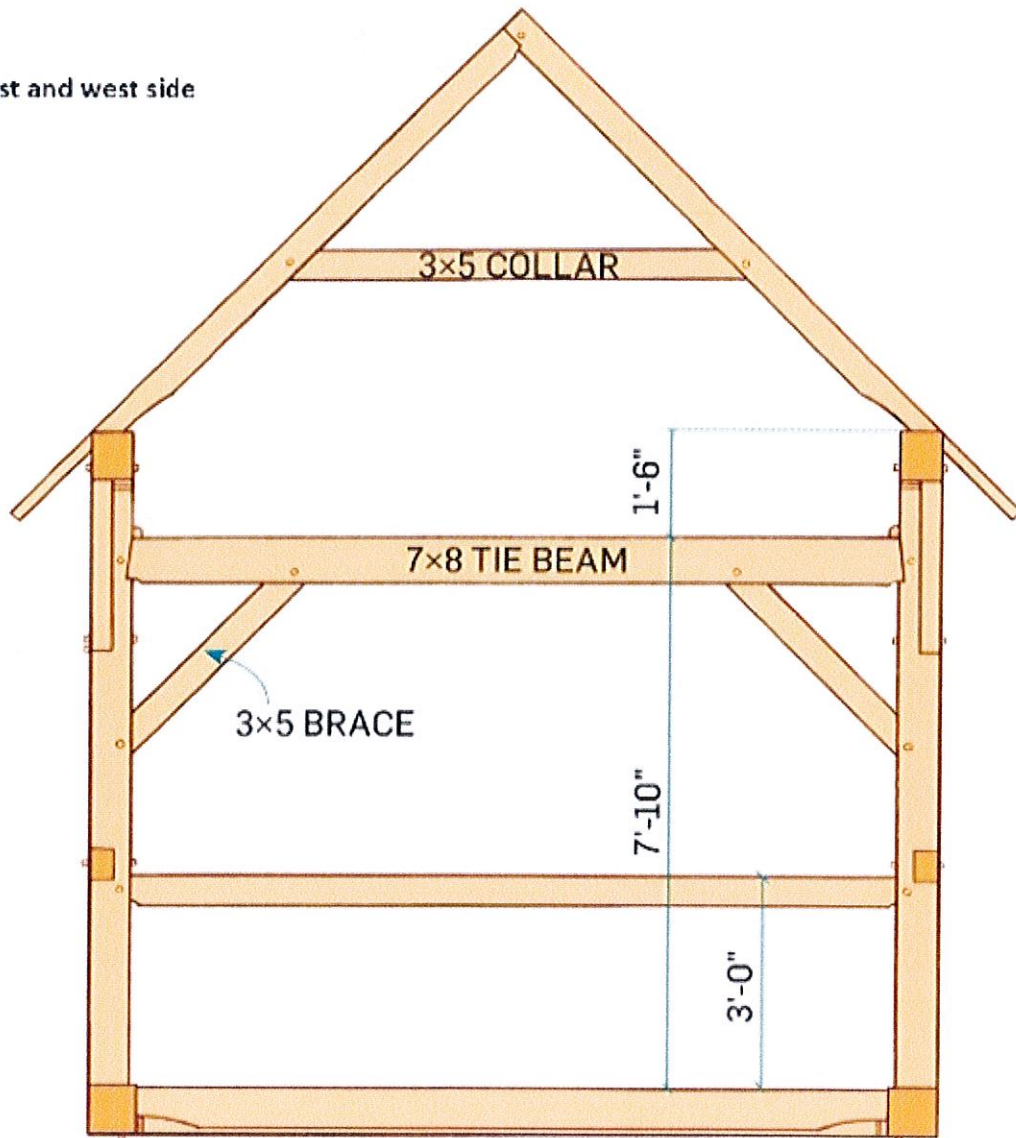

Materials

Wood; rough cut pine

Frame - list on next page

Wall cover; 12"x1"

Roof: 12 x 18 dark gray slate, attached to underlying 12 x 1 rough cut pine planks with 1.5" copper nails, the roof ridge is covered with copper flashing

TIMBER LIST FOR THE FRAME

TIMBER TYPE	NOMINAL (INCH) SIZE (WIDTH × DEPTH)	QUANTITY/ LENGTH (FEET)	BF (BOARD FOOTAGE)
<i>Sills</i>	8×8	2/12, 2/16	299
<i>Tie beams</i>	7×8	3/12	168
<i>Plates</i>	7×8	2/18	149
<i>Posts</i>	7×7	6/10	245
<i>Joists</i>	5×7	5/12	175
<i>Rafters</i>	5×5	18/10	375
<i>Wall girts</i>	4×5	5/8, 1/12	87
<i>Door posts</i>	4×5	2/8	27
<i>Collars</i>	3×5	2/10	25
<i>Braces</i>	3×5	7/10*	87.5
<i>Total**</i>			1637.5
<i>Pins</i>		12 1-inch dia., 75 ¾-inch	
<i>Hardwood wedges</i>	2¾ inch at wide end, tapered at ¾ inch in 8 inches	6/12"	Make wedges slightly narrower than 1½ inches

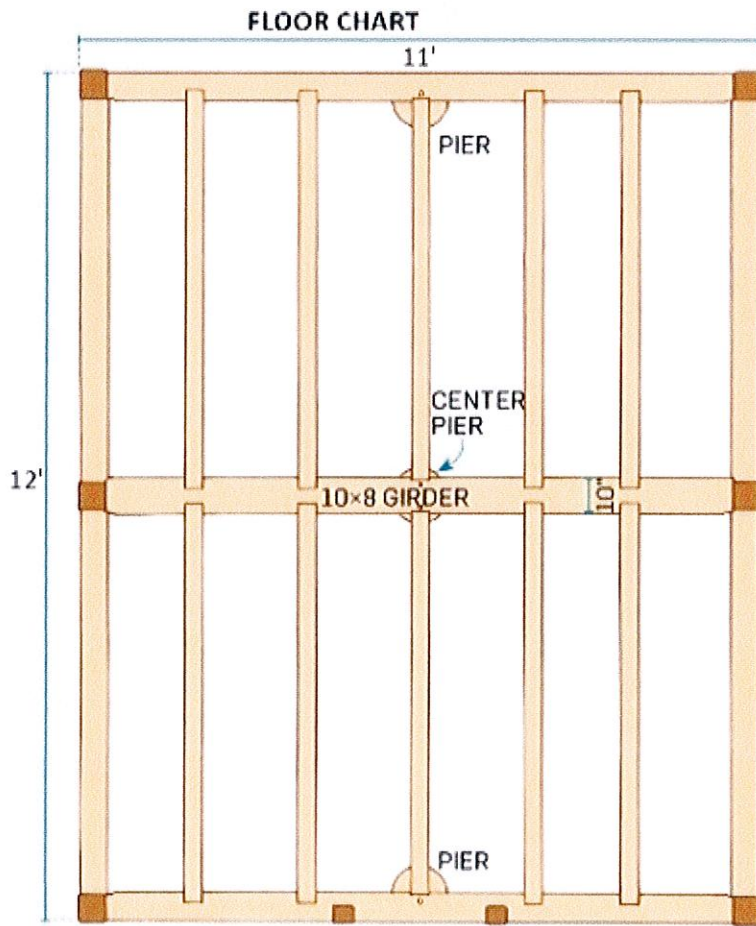

Side facing north (with a door and a window)

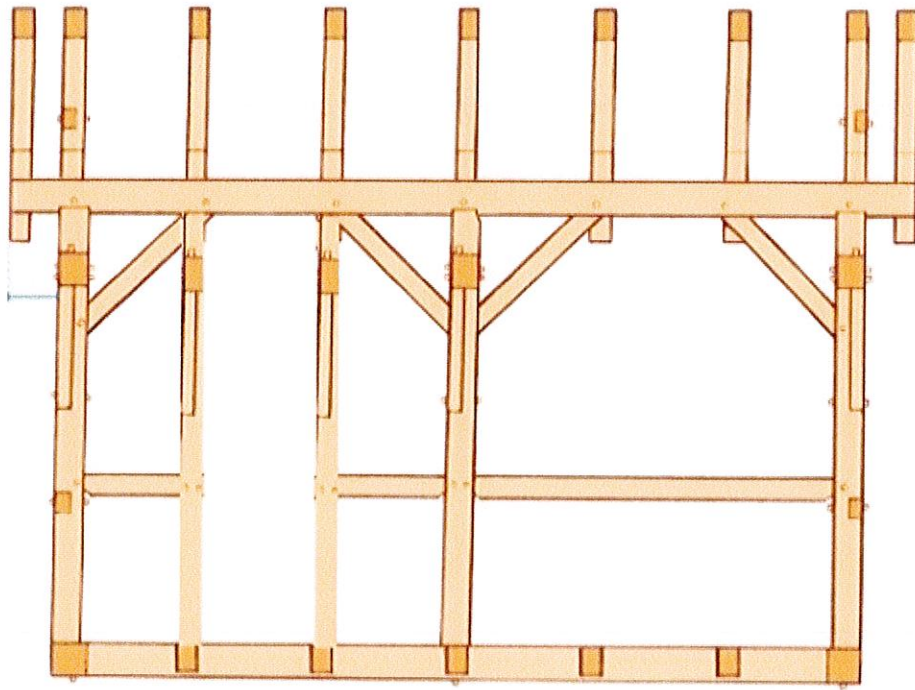

Side facing south

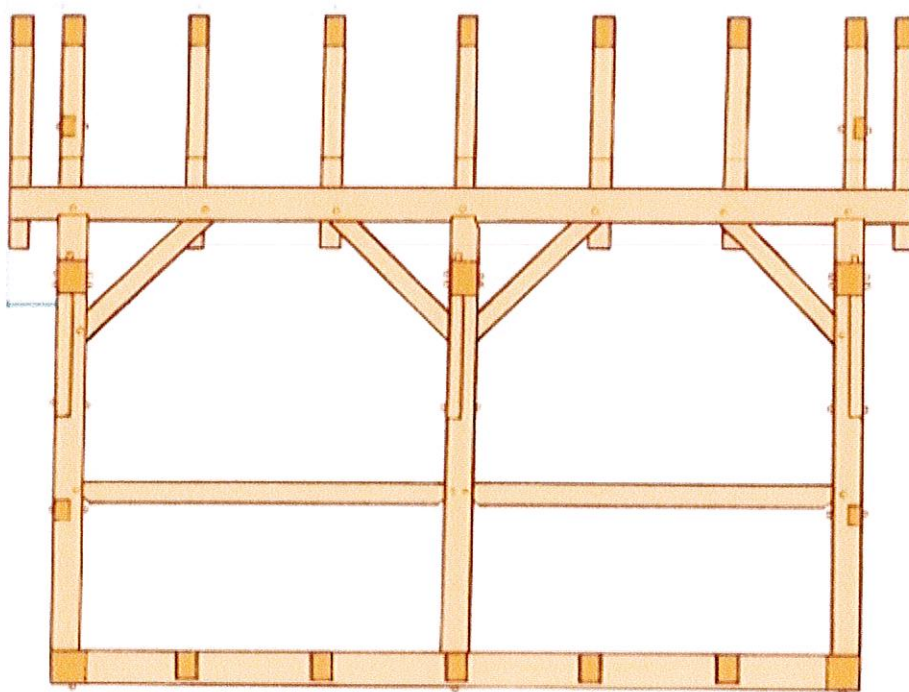

East and west side

